

Kantech IP Link

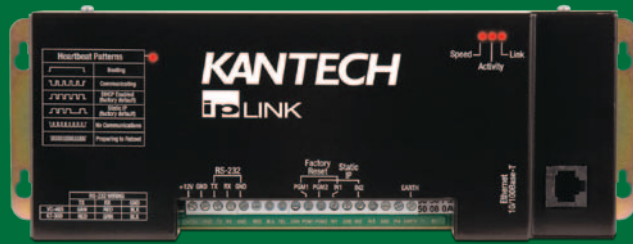

Features That Make a Difference:

- Powerful connection between Kantech KT-100 and KT-300 controllers and TCP/IP network applications
- Allows Kantech controllers to interface easily with other TCP/IP protocol-compatible devices
- 10/100 Base-T Ethernet compatible interface
- RJ45 connector allows direct connection to CAT5 network cabling
- RS-232 port allows any Kantech controller with a serial port to be networked together using Ethernet networking
- Cost-effective solution for managing multiple remote sites
- Communicates over the network only as required, keeping network traffic down to a minimum
- Plug and play setup makes it quick and easy to use with EntraPass security management software
- Supports up to 32 door controllers per device
- Compatible with EntraPass Special, Corporate and Global Editions (Global Edition with Multi-Site Gateway only)

Network Connection Made Easy

The Kantech IP Link (KT-IP) is an RS-232 to TCP/IP interface that connects KT-100 or KT-300 door controllers to a network. It reduces cabling, and gives the controllers real-time access to information and enhanced functionality by leveraging the bi-directional communications capabilities of TCP/IP. KT-IP integrates seamlessly into an existing TCP/IP network and requires no changes to existing equipment, network, or systems. The KT-IP is compatible with EntraPass security management software and uses 128-bit AES encryption to ensure secure communication.

The data transfer from the controller is asynchronous to the actions on the TCP/IP network. The KT-IP manages polling

of door controllers and communicates with the EntraPass Multi-Site Gateway only when an event has occurred. Communication integrity is ensured through a heartbeat signal, which is sent at a regular interval to the EntraPass software. This asynchronous communication significantly reduces the amount of bandwidth required to manage your access control system over the network.

The KT-IP is easy to set up. Use an EntraPass workstation, a web browser or the KT-Finder, an intuitive standalone application designed to locate and configure the KT-IP. In most installations, EntraPass software automatically detects and configures the KT-IP using the MAC address.

Specifications

Physical

Weight	
KT-IP	0.6 kg (1.3 lbs)
KT-IP-PCB	0.18 kg (0.4 lbs)
KT-IP-CAB	1.81 kg (4.0 lbs)
Dimensions	
KT-IP	26.7 x 9.5 x 3.12 cm (10.5 x 3.72 x 1.23 in)
KT-IP-PCB	22 x 8.30 x 2.5 cm (8.66 x 3.25 x 1.0 in)
KT-IP-CAB	28.4 x 29.7 x 7.8 cm (11.2 x 11.7 x 3.1 in)
Communication Ports	RJ-45 Ethernet 10/100Base-T and RS-232
Communication Speed	Up to 115200 baud for serial communication
Flash ROM	2 MB
RAM	8 MB
Compatibility	KT-100 and KT-300 door controllers
Number of KT-IP	Up to 512 KT-IP per Multi-Site Gateway Up to 64 IP Links per EntraPass Special Edition

Operational

EntraPass Version 4.0 and higher

Environmental

Operating Temperature 0°C to 49°C (32°F to 122°F)
Humidity 0 to 85% non-condensing, indoor use only

Electrical

DC Power Input 12 VDC
Input Current Max: 175 mA, Typical: 125 mA

Regulatory

Compliance FCC Part 15 Class A
EN55022 (CISPR22)
EN55024
CE
C-Tick
UL294
Certifications RoHS
Environmental WEEE

Model Numbers

KT-IP IP Link module with wall mount enclosure and accessories (ground wire, plastic stand off, cable/connector)
KT-IP-PCB IP Link module PCB only with accessories (ground wire, plastic stand off, cable/connector)
KT-IP-CAB Metal cabinet for KT-IP-PCB

System Diagram

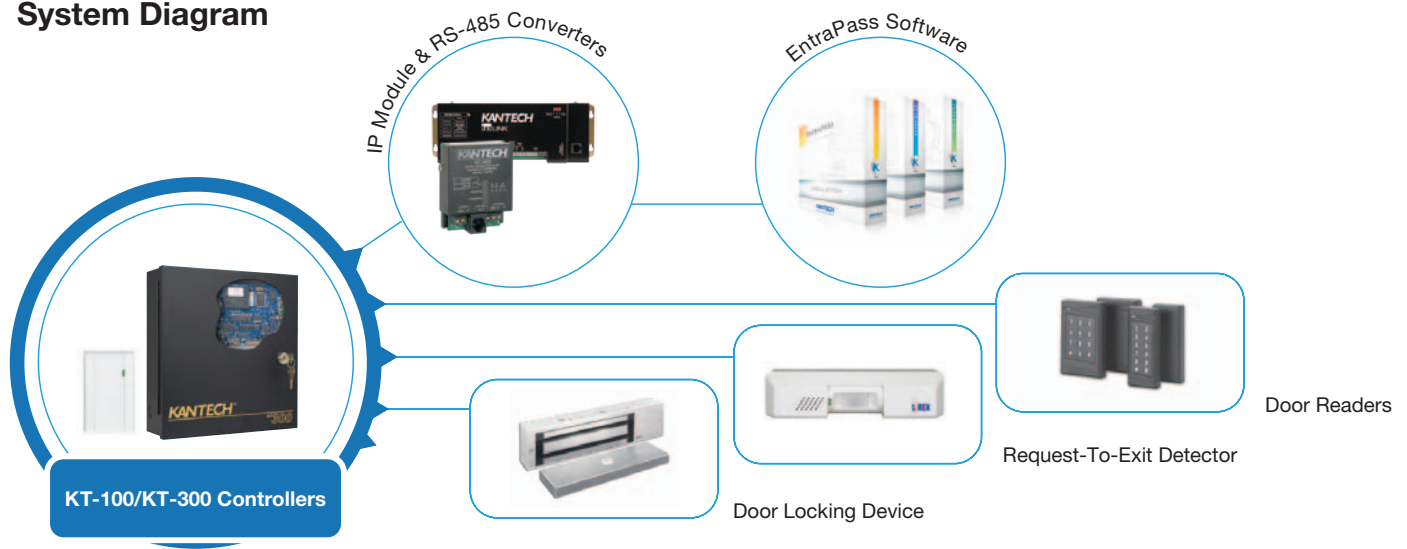

Related Products



KT-100/KT-300
Door Controllers



EntraPass Security
Software



VC-485
RS-232 to RS-485 Converter

Approvals



www.kantech.com